

2-stage filter for 3-phase systems



Description

- Available as line-filter with normal or high attenuation
- Very high symmetrical and asymmetrical attenuation loss
- In the frequency range from 10kHz up to 300MHz

Standards

- IEC 60939
- UL 1283
- EN 133 200

Approvals

- VDE License Number: 40004666

Applications

- Voltage rating 480 VAC for world wide acceptance
- Protection against interference voltage from the mains
- For standard and industrial applications
- Qualified for use in equipment according IEC/EN 60950

References

[General Product Information](#)

Weblinks

[Approvals](#), [RoHS](#), [CHINA-RoHS](#), [e-Store](#), [SCHURTER-Stock-Check](#), [Distributor-Stock-Check](#)

Technical Data

Rated Current	8 - 64 A @ Ta 40 °C
Rated Voltage	480VAC, 50/60 Hz
Approval for	8 - 64 A @ Ta 40 °C / 480VAC; 50 Hz
Leakage Current	industrial < 5 mA (440V / 50Hz)
Dielectric Strength for 480 VAC	2.25 kVDC between 3 kVDC between L-PE Test voltage (2 sec)
Number of Filter Stages	2
Weight	1.7 - 7.45 kg
Material: Housing	Metal
Sealing Compound	UL 94V-0

Mounting	Screw-on mounting on chassis, from top
Terminal	Screw Clamp
Operating Temperature [°C]	-25 °C to 100 °C
Climatic Category	25/100/21 acc. to IEC 60068-1
Degree of Protection	IP 20 acc. to IEC 60529
Protection Class	Suitable for appliances with protection class I acc. to IEC 61140
MTBF	> 200'000h acc. to MIL-HB-217 F

Dimensions

Case 27-3

Case 31-3

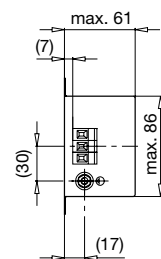
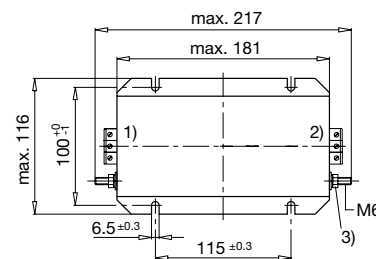
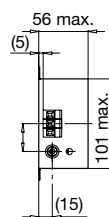
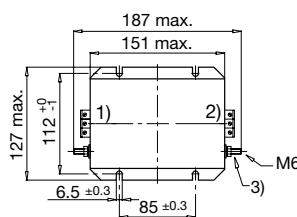

- 1) Line
- 2) Load
- 3) Nut torque 3...4 Nm

Case 32-7

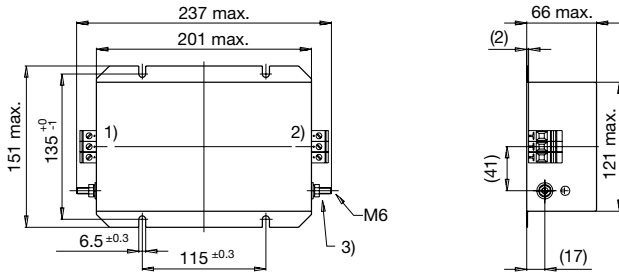

Case 37-3

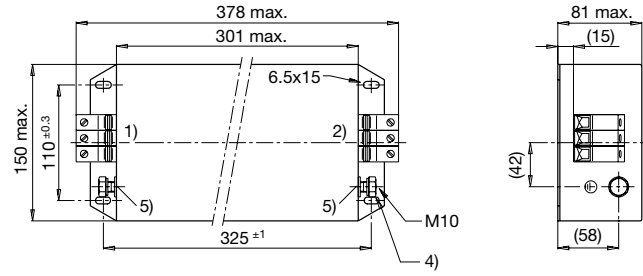

Case 38-3

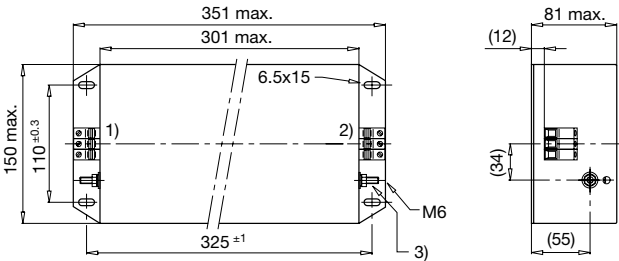

Case 40-3

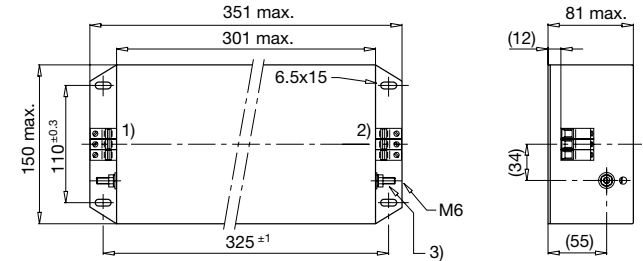

- 1) Line
- 2) Load
- 3) Nut torque 3...4 Nm
- 4) Nut torque 10...17 Nm
- 5) Do not unscrew lock-nut

Technical data to the filter components

Rated Current [A]	Characteristic	L [mH]	C1 [µF]	C2 [µF]	C3 [nF]	C4 [nF]	R1 [MΩ]	R2 [MΩ]	R3 [MΩ]	R4 [MΩ]
8	Excellent attenuation	8	1.0	1.0	2.2	47	-	-	1	1
12	Excellent attenuation	5.5	1.0	1.0	2.2	47	-	-	1	1
16	Excellent attenuation	4.5	1.0	1.0	2.2	47	-	-	1	1
25	Excellent attenuation	4.5	1.0	2.2	2.2	47	-	-	1	1
64	Excellent attenuation	0.85	2.2	2.2	4.4	100	-	1	1	1
36	Excellent attenuation	3	1.0	2.2	4.4	47	1	1	1	1
50	Excellent attenuation	1.5	2.2	2.2	4.4	100	1	1	1	1
25	High attenuation	2.4	1.0	2.2	2.2	47	-	-	1	1
50	High attenuation	1	2.2	2.2	4.4	100	-	1	1	1
36	High attenuation	1.5	1.0	2.2	4.4	47	-	1	1	1

Diagrams

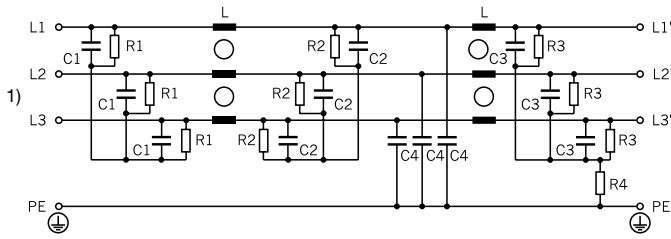

1) Power Line

Attenuation Loss

--- differential mode ____ common mode

Industrial Version

8A (FMBC-0927-0810)

12A (FMBC-0927-1210)

16A (FMBC-0931-1610)

25A (FMBC-0932-2510)

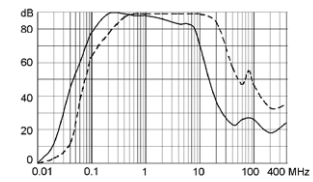
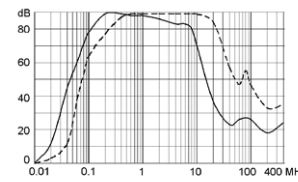
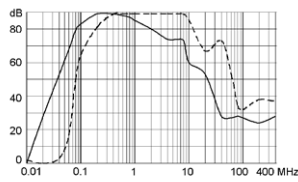
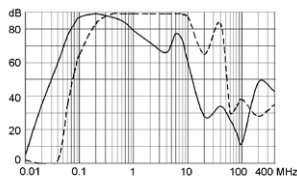

25A (FMBC-0932-2510L)

36A (FMBC-0938-3610)

36A (FMBC-0940-3610L)

50A (FMBC-0938-5010)

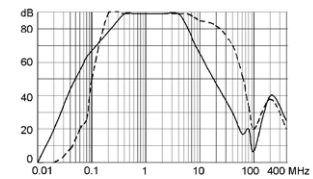
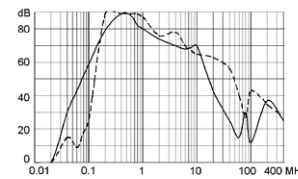
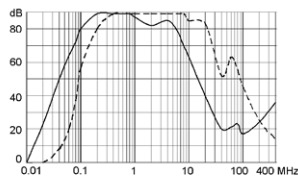
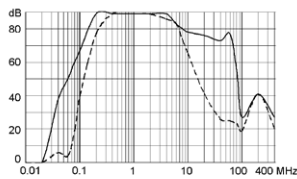

50A (FMBC-0938-5010L)

64A (FMBC-0937-6410)

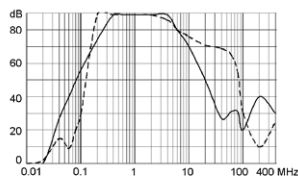
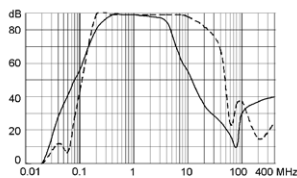

Variants

[Distributor-Stock-Check](#) | [SCHURTER-Stock-Check](#) | [e-Store](#)

Rated Current [A]	Characteristic	P_{loss} [W]	Contact Resistance [mΩ]	Leakage Current ¹⁾	Weight [kg]	Clamps [mm ²]	Case	Order Number
12	Excellent attenuation	10	23	19	1.9	4	27-3	FMBC-0927-1210
8	Excellent attenuation	10.6	55	19	1.7	4	27-3	FMBC-0927-0810
16	Excellent attenuation	14.6	19	19	2.28	4	31-3	FMBC-0931-1610
25	Excellent attenuation	18.8	10	19	3.4	6	32-7	FMBC-0932-2510
36	Excellent attenuation	29.2	7.5	19	7.4	6	38-3	FMBC-0938-3610
50	Excellent attenuation	30.3	4.0	39	7	10	38-3	FMBC-0938-5010
64	Excellent attenuation	47.9	3.9	39	7.45	25	37-3	FMBC-0937-6410
36	High attenuation	18.3	4.7	19	6.5	6	40-3	FMBC-0940-3610L
25	High attenuation	20.7	11	19	3.5	6	32-7	FMBC-0932-2510L
50	High attenuation	25.9	3.45	39	7	10	38-3	FMBC-0938-5010L

1) Worst case leakage current acc. IEC60950 - Annex G4 (situation with two interrupted lines). Nominal leakage current acc. IEC6950 - 5.2.5. can be found in section technical data.

Packaging unit 1 Pcs